

Te Hāpua: Halswell Centre

ARRIVING NOVEMBER 2015



May 2015

Te Hāpua: Halswell Centre is a new library and community facility being built alongside the Halswell Aquatic Centre site. The complex, fronting onto Halswell Road, will create a hub for the rapidly-growing Halswell community.

What's in a name?

The facility has just been given a proper name - since it was first mooted in 2009, it's been creatively known by the team as "Halswell Library, Pool and Community Facility". Something catchier was needed.

For obvious reasons, something less clunky was needed, and it was decided to ask the public. In a competition run from December 2014 – January 2015, Christchurch City Council received 162 valid suggestions. A panel of Council staff and rūnanga sorted through the entries and selected six finalists, which were voted on by the public with 766 votes between them.

The winning suggestion was "The Halswell Centre" – you can't go wrong! The current Halswell Library hosted a morning of muffins and coffee on 17 April to present Selwyn Eagle, one of the winning entries, with a pool pass. The other two winners were unable to attend but received their prizes in due course.



Selwyn collects his prize and his share of the muffins.

Why Te Hāpua?

Throughout the naming process, the Council consulted with Mahaanui Kurataiao Ltd (MKT) and the two local rūnanga on a te reo Māori name for the facility to complement the competition name and suggest the local area. The consensus was for Te Hāpua, which roughly translates to "the lagoons". This refers to the outdoor pool, as well as the location of the complex alongside Te Tauawa-a-Maka/Nottingham Stream, an upper tributary of the Huritini/Halswell River. This is in turn an important source of Lake Ellesmere (Te Waihora), which is very important to rūnanga.



Want to work at Te Hāpua: Halswell Centre?

Library recruitment open evenings in June

The library is recruiting a range of staff for full- and part-time positions delivering community-responsive programs, events and services. Come along to an open evening to learn about these roles, hear from current Christchurch City Libraries staff and how to apply.

Wednesday 3 June, 6pm–7pm,
Upper Riccarton Library

Wednesday 10 June,
6pm–7pm, South Library

Thursday 25 June,
6pm–7pm, South Library

Construction update

- The north car park has been completed, with only the car park lighting to be installed. Work is continuing on the South car park, including the planting of trees to green things up a little.
- Almost all of the structural steel and roof framing has gone up and is being painted.
- Half the timber frames for the roof, as well as the sarking underlay (wood panels that go just under the roof to provide support, for those of you who don't speak roofer), have been installed. Work on installing the roofing itself is now underway.
- The windows are currently being manufactured offsite by Thermosash, and pipework for the sprinklers is now being installed.

What's next?

Over the next month we'll be completing the structural steel framing; continuing with timber wall and roof framing, sarking and roofing; starting aluminium window installation; continuing to install fire sprinkler pipework and other services; and installing lights to car parks.

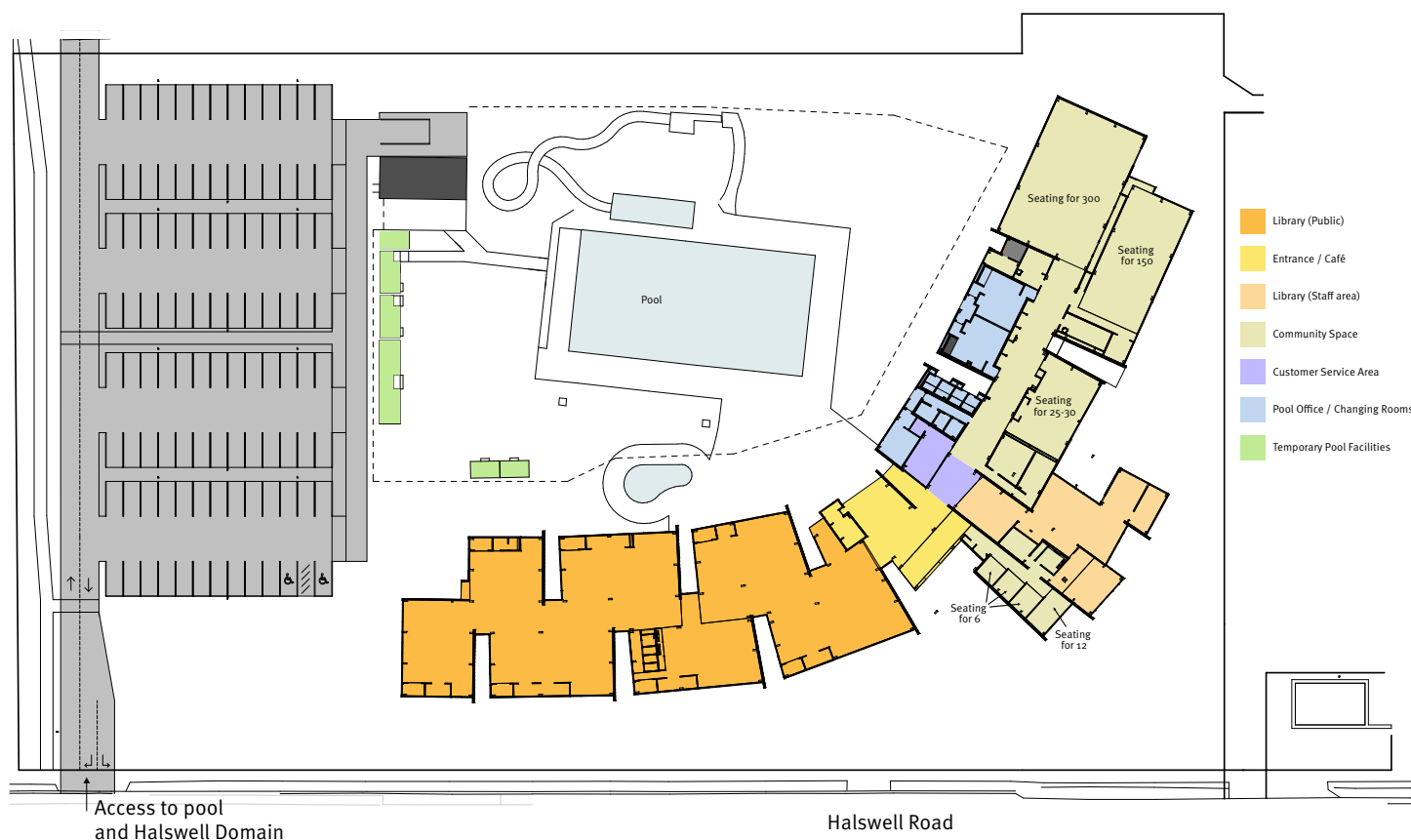

For more information:

Visit www.ccc.govt.nz/TeHapua

Email tehapua@ccc.govt.nz

Phone Fingertip Library on (03) 941 7923