

— C/T 323/202 —  
— "Wooden Building" —

NO. 28

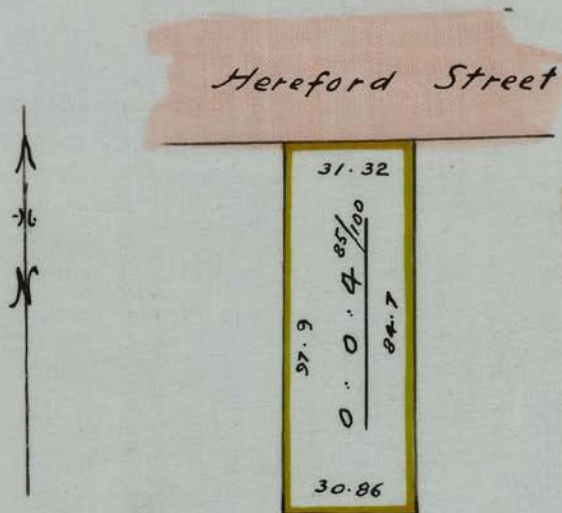

— Scale:- 50 links = 1 inch —

- Transfer 205488 { Party Wall Rights, R.O.W. (Foot)  
& other Easements.
- " — 205531 : Easement Light & Air
- " — 240345 : Party Wall Easement.
- " — 240346 : { Storm Water Easement & R.O.W.  
Subject to right to build over etc.

A. J. Stacey  
Nov. 1946